

PROJECT NAME: MAHER SELECT

Opposite Club O7, Plot No 3, Maher Street



Property Type:	Flat/Appartment
Builder Name:	Vishwanath Realt
Locality:	Shela
City:	Ahmedabad
State:	Gujarat
Availability:	01-08-2025
Project Type:	Ongoing
Sample House Ready:	No

Rera ID: PR/GJ/AHMEDABAD/SANAND/AUDA/RAA08927/210821

Description: 3 BHK Premium Apartments

Architect Name: Groundwork Architecture Structure Consultant: M/S. PNL Engineering Consultant Pvt Ltd.

Property Facilities: Intercom Vastu Compliant

Building Amenities:	CCTV Camera	Garden	Fire Safety
	Visitor Parking	Lift	Gym
	Kitchen	Intercom	Power Backup
	Swimming Pool	Security	Club House
	Multi Purpose Hall	Water Body	House Keeping
	Borewell	Kid's Play Area	Yoga Room
	Tt & Billiard	Wash Room	Games Room
	Driver Lounge	Waste Disposal	Vastu Compliant
	Terrace Garden	Boom Barrier	Jogging Track
	Children's Pool	Multi Purpose Court	Senior Citizen Area
	Solar Panel	Rain Water Harvesting	Entrance Foyer
	Gated Community		

Specification:

Interior Walls :	Internal smooth finished plaster with 2 coat of birla putty. Exterior double coated sand faced plaster with acrylic paint.
Flooring :	Double charge vitrified or equivalent flooring in living and dining areas, kitchen and all bedrooms. Kota stone or similar in wash area.
Doors :	Decorative wooden main door with wooden frame & brass/s.s. fittings.
Electrical :	Three phase concealed wiring with adequate A.C, Gyser, T.V. and Telephone points in each unit.
Kitchen :	Polished natural granite platform. Stainless steel kitchen sink. Vitrified tiles dado up to lintel level on wall above kitchen platform.
Doors & Windows :	Laminated Flush doors with wooden frame in all bedrooms and bathrooms & brass/s.s. fittings. Fully glazed powder coated aluminium sliding windows with stone revile.
Bathrooms :	Ceramic tile flooring in all bathrooms. Coloured tiles dado up to lintel level.

PROJECT DETAILS

Sr. No.	Type	Constructed Area (SBA)	Area Unit	Parking
1	3 BHK	1730 Sq.Ft. Super Builtup	Sq. Ft.	1

- Stamp duty, Registration charges, Legal charges, Auda, Electricity, Corporation, Parking and all other extra charges shall be borne by the purchaser.

- GST, TDS and any other taxes levied in future shall be borne by the purchaser.

PROPERTY PHOTOS

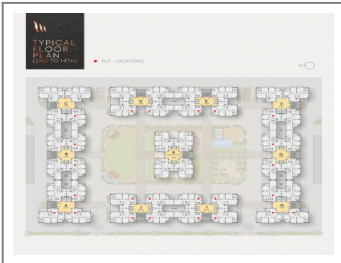
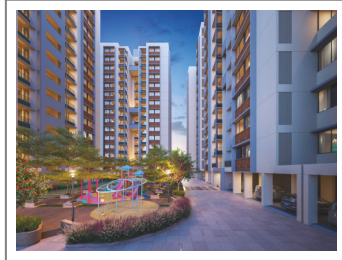
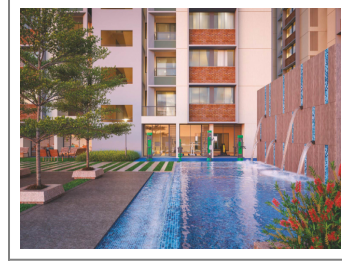
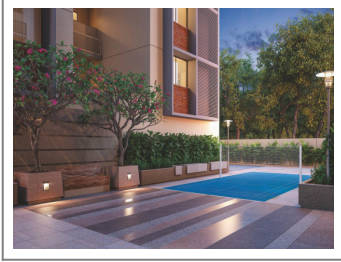

Note : All visuals, images, facilities and other details shown here are for presentation only and are subject to change by the builder/developer/owner without any obligation.

Disclaimer : propertyvastu.com/ is a online Real Estate platform for Seller and Agent/Broker/Customer/Buyer to facilitate their real estate needs. propertyvastu cannot control any transactions between the Seller and the Agent/Broker/Customer/Buyer. Properties details displayed on the propertyvastu.com/ website are for informational purposes only. Information regarding real estate projects including property/project details, by various Builder(s)/Developer(s)/Broker(s) who have advertised their property/project. Nothing contained herein shall be deemed to constitute legal advice, solicitations, marketing, offer for sale, invitation to offer, invitation to acquire by the developer/builder or any other entity. propertyvastu shall neither be responsible nor liable to mediate or resolve any disputes or disagreements between the Seller and Agent/Broker/Customer/Buyer. Hereby we strongly advised to visit the relevant RERA website before taking any decision based on the contents displayed on the website.