

PROJECT NAME: SWARA SAPPHIRE

Hirabaug Crossing Road, Opp. Ips Quarters, Behind Kalyan Jewellers



Property Type:	Flat/Appartment
Builder Name:	Swara Building Ha
Locality:	Ambawadi
City:	Ahmedabad
State:	Gujarat
Availability:	Immediate
Project Type:	Completed
Sample House Ready:	Yes

Rera ID: PR/GJ/AHMEDABAD/AHMEDABAD CITY/AUDA/RAA05043/140319

Description: 3 BHK Premium Apartments

Architect Name: MONTU PRAJAPATI

Property Facilities: Video Doorphone Intercom Gas Connection
Vastu Compliant

Building Amenities: CCTV Camera Garden Fire Safety
Visitor Parking Lift Gym
Intercom Power Backup Security
Piped Gas Club House Theater
Multi Purpose Hall House Keeping Borewell
Kid's Play Area Tt & Billiard Games Room
Waste Disposal Vastu Compliant Terrace Garden
Boom Barrier Senior Citizen Area Gazebo
Entrance Foyer Gated Community

Specification:

Structure :	Earthquake resistant R.C.C. frame Structure.		
Interior Walls :	Inside: Putty finish Outside: Acrylic paint / Texture MS Fabrication/ Railing: Enamel Paint with Anti Rust treatment Double coat sand faced plaster on external walls and single coat mala plaster on inside walls.		
Flooring :	Premium vitrified tiles flooring Wooden look vitrified tile flooring for Master Bedroom Anti-skid flooring in wash area and Balcony		
Doors :	Main Door - Flush Door with both side laminated sheet with wooden frame Internal Door- Flush door with both side laminated sheet with granite frame		
Electrical :	Conceal ISI copper wiring with modular switches Broadband internet connection conduit Multi-dwelling Unit provision for DTH Connection 3 phase power connection DB with ELCB/ MCCB to ensure maximum safety		
Security Camera :	Video door phone security system to be linked with reception and access control in the lobby Entire premises covered under CCTV surveillance		
Kitchen :	S.S. Sink Flooring: Vitrified Tiles Platform: Natural granite Dedo: Premium glazed tiles Store Shelf : DP Kota / Granite shelf		
Wash Area :	Floor: Kota or Rustic vitrified tiles Dedo: Premium ceramic or vitrified tiles		
Doors & Windows :	Powder Coated aluminium section sliding glass windows with granite window jamb.		
Bathrooms :	Premium ceramic tiles upto lintel level Granite / Counter basin EWC-Wall hung type- Jaguar, Kohler /equivalent CP Brass fitting - Jaquar, Kohler / equivalent		
Total No. of Tower :	1	No. Flats in Tower :	20
No. Floor in Tower :	5	No. of Flats per Floor :	4
Flat Size :	2223 Sq.Ft. Super Builtup	Allocate Parking :	yes

PROJECT DETAILS

Sr. No.	Type	Constructed Area (SBA)	Area Unit
1	3 BHK	2223 Sq.Ft. Super Builtup	Sq. Ft.

- Stamp duty, Registration charges, Legal charges, Auda, Electricity, Corporation, Parking and all other extra charges shall be borne by the purchaser.

- GST, TDS and any other taxes levied in future shall be borne by the purchaser.

PROPERTY PHOTOS

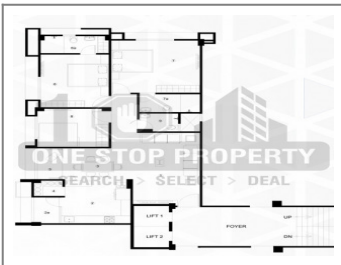
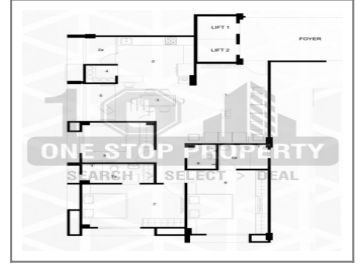
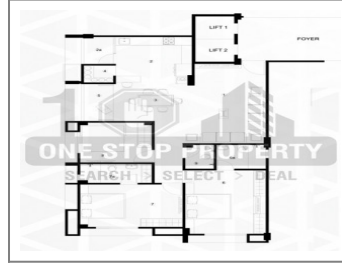
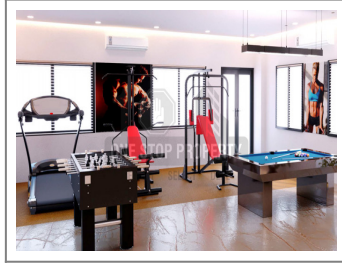

Note : All visuals, images, facilities and other details shown here are for presentation only and are subject to change by the builder/developer/owner without any obligation.

Disclaimer : propertyvastu.com/ is a online Real Estate platform for Seller and Agent/Broker/Customer/Buyer to facilitate their real estate needs. propertyvastu cannot control any transactions between the Seller and the Agent/Broker/Customer/Buyer. Properties details displayed on the propertyvastu.com/ website are for informational purposes only. Information regarding real estate projects including property/project details, by various Builder(s)/Developer(s)/Broker(s) who have advertised their property/project. Nothing contained herein shall be deemed to constitute legal advice, solicitations, marketing, offer for sale, invitation to offer, invitation to acquire by the developer/builder or any other entity. propertyvastu shall neither be responsible nor liable to mediate or resolve any disputes or disagreements between the Seller and Agent/Broker/Customer/Buyer. Hereby we strongly advised to visit the relevant RERA website before taking any decision based on the contents displayed on the website.