

PROJECT NAME: SHILP ANANTA

Opposite, Club 07, Khadiya



Property Type:	Flat/Appartment
Builder Name:	Shilp Group
Locality:	Shela
City:	Ahmedabad
State:	Gujarat
Availability:	01-09-2023
Project Type:	Ongoing
Sample House Ready:	Yes

Rera ID: PR/GJ/AHMEDABAD/AHMEDABAD CITY/AUDA/MAA08006/050221

Description: 2 BHK Exclusive Apartments

Architect Name: DIPIKA CHAVDA Structure Consultant: VIREN D PAREKH

Property Facilities: Vastu Compliant

Building Amenities:	CCTV Camera	Garden	Fire Safety
	Visitor Parking	Lift	Gym
	Power Backup	Security	Club House
	Library	Multi Purpose Hall	Water Body
	House Keeping	Borewell	Kid's Play Area
	Yoga Room	Tt & Billiard	Games Room
	Driver Lounge	Waste Disposal	Vastu Compliant
	Boom Barrier	Jogging Track	Multi Purpose Court
	Senior Citizen Area	Gazebo	Entrance Foyer
	Gated Community		

Specification:

Interior Walls :	Internal Smooth Finish Plaster With Double Coat Birla Putty. External Double Coat Sand Face Plaster Or Texture With Acrylic Paint.		
Flooring :	Vitrified Tile Flooring In Entire Apartment.		
Doors :	Main Door - Decorative Main Door With Wooden Frame. Internal Door - Flush Door With Enamel Paint.		
Electrical :	ISI Modular Switches. ISI Wires. Distribution Board With MCB For Safety And Protection.		
Kitchen :	Granite Platform With Stainless Steel Sink Along With Electrical Point For Water Purifier. Designer Glaze Tile Dedo Upto Lintel Level.		
Wash Area :	24 Hours water supply.		
Doors & Windows :	Sliding Aluminium Window Section With Anodized Or Powder Coated.		
Bathrooms :	Designer Ceramic Or Glaze Tile Upto Lintel Level. CP Fittings - Chrome Plated Branded Bathroom Fittings.		
Total No. of Tower :	10	No. Flats in Tower :	610
No. Floor in Tower :	14	No. of Flats per Floor :	4
Allocate Parking :	yes		

PROJECT DETAILS

Sr. No.	Type	Constructed Area (SBA)	Area Unit	Parking
1	2 BHK	1085 Sq.Ft. Super Builtup	Sq. Ft.	1

- Stamp duty, Registration charges, Legal charges, Auda, Electricity, Corporation, Parking and all other extra charges shall be borne by the purchaser.

- GST, TDS and any other taxes levied in future shall be borne by the purchaser.

PROPERTY PHOTOS

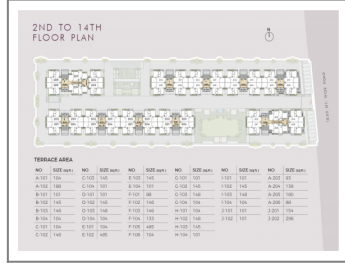
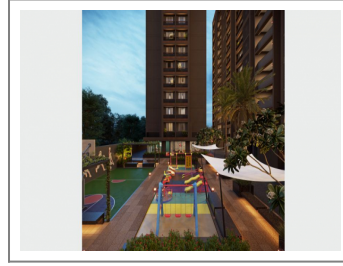
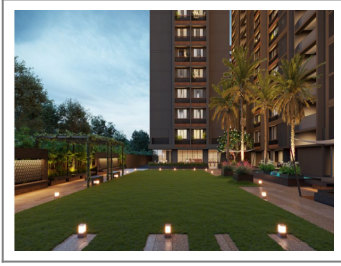

Note : All visuals, images, facilities and other details shown here are for presentation only and are subject to change by the builder/developer/owner without any obligation